

ANNEX D (2)

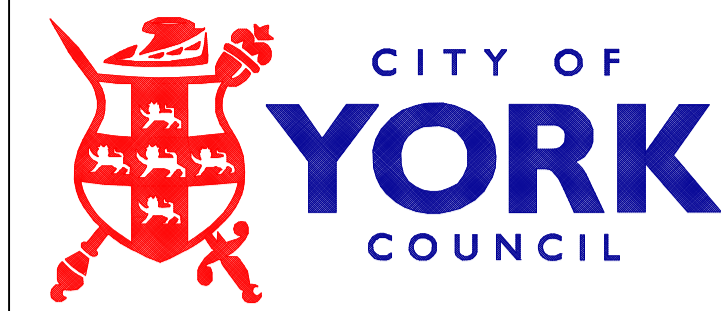

Transport Systems Team
 West Office, Station Rise, York, YO1 6GA
 Tel: 01904 552827
 www.york.gov.uk

NOTES

- DO NOT SCALE FROM THIS DRAWING.

KEY

BASED UPON THE ORDNANCE SURVEY MAPPING WITH THE PERMISSION OF THE CONTROLLER OF HER MAJESTY'S STATIONERY OFFICE, CROWN COPYRIGHT. UNAUTHORISED REPRODUCTION INFRINGES CROWN COPYRIGHT AND MAY LEAD TO PROSECUTION OR CIVIL PROCEEDINGS. CITY OF YORK COUNCIL, LICENCE NO. 1000 20818, 2006

ISSUE/REVISION

I/R	DATE	DESCRIPTION
P01	07.08.2019	FIRST ISSUE

SHEET TITLE

VICTORIA BAR ACCESS
 OPTION 5/6 - EXIT ONLY

DRAWING NUMBER

TST-VICBAR-P-005/006

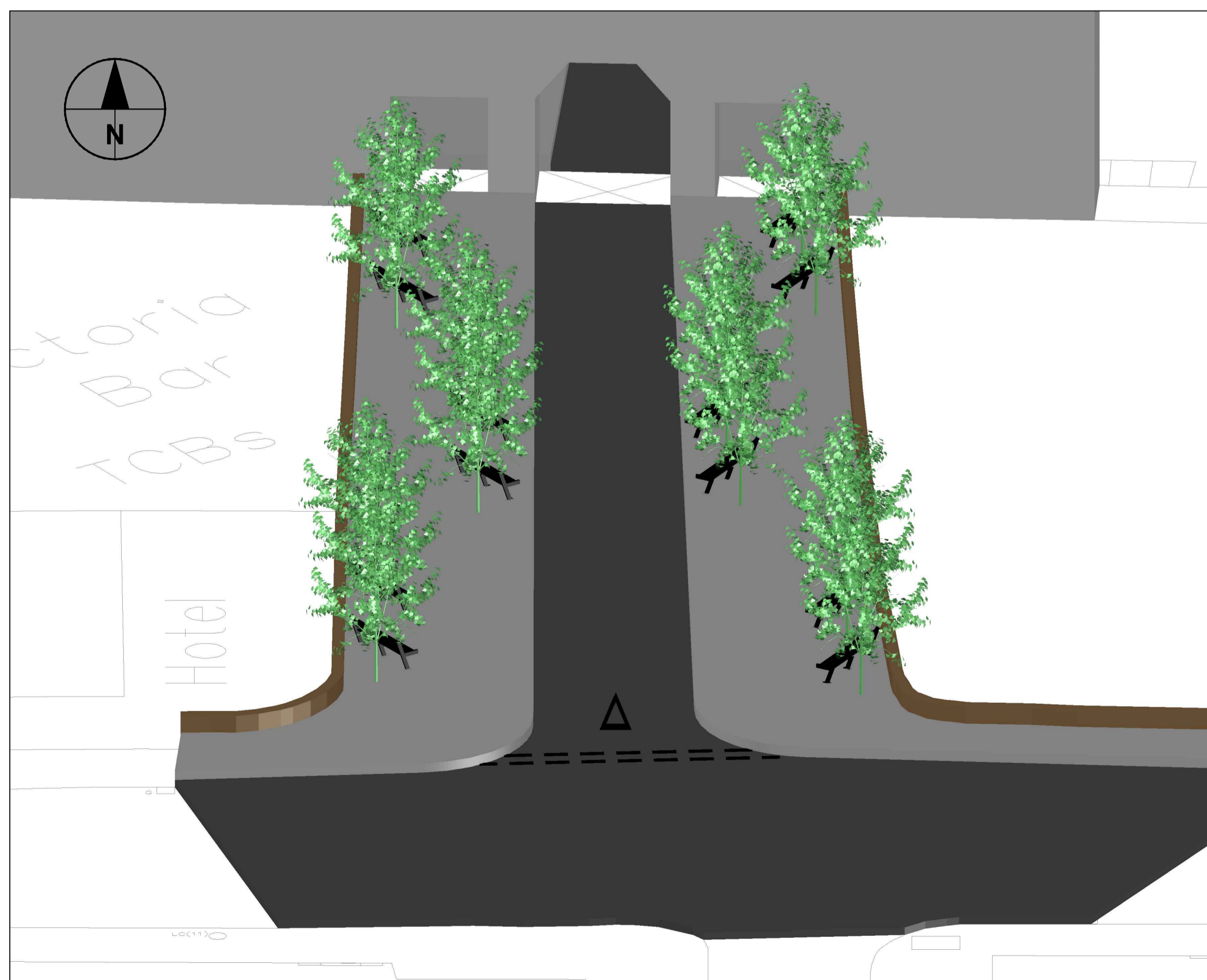
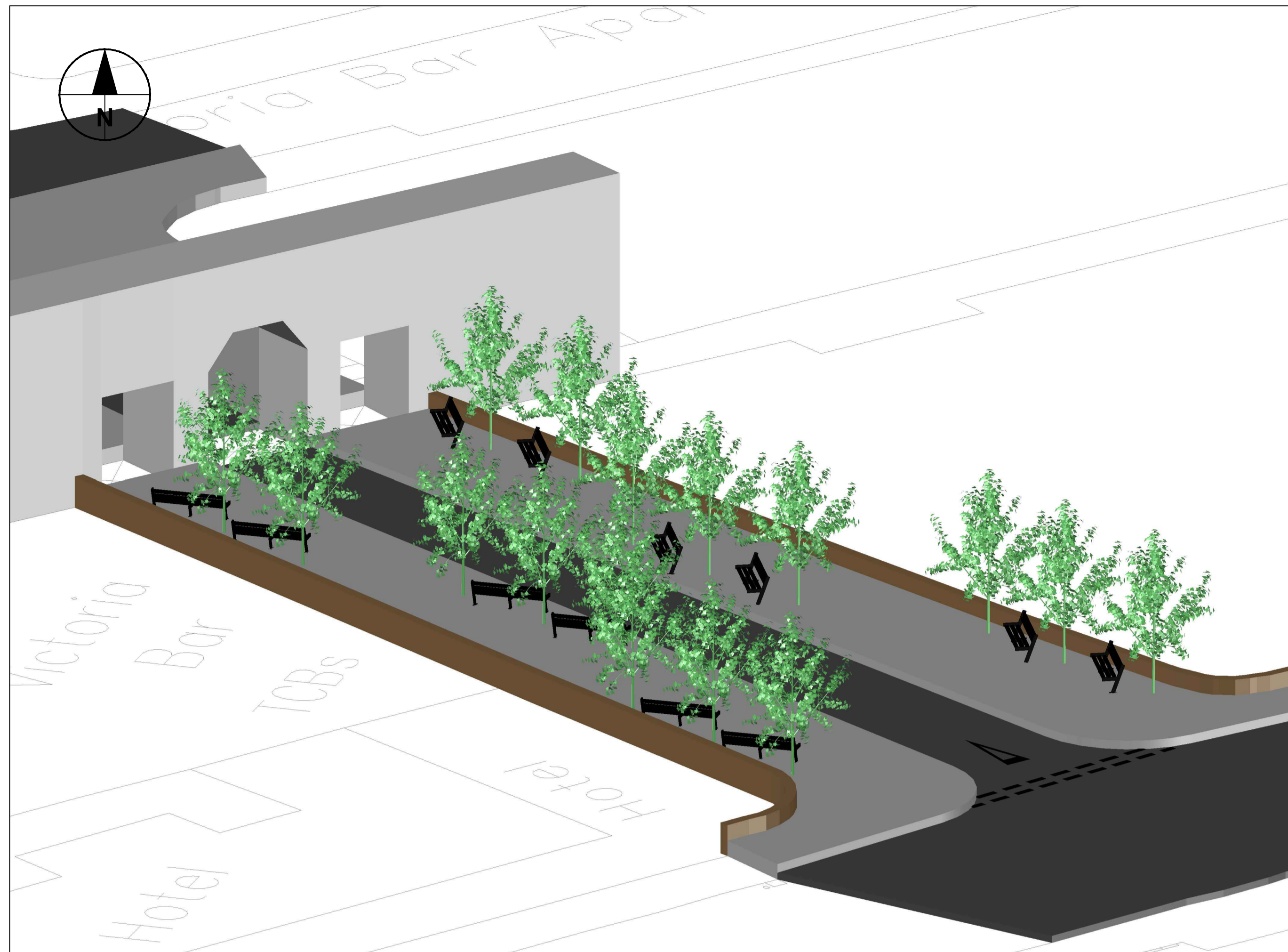
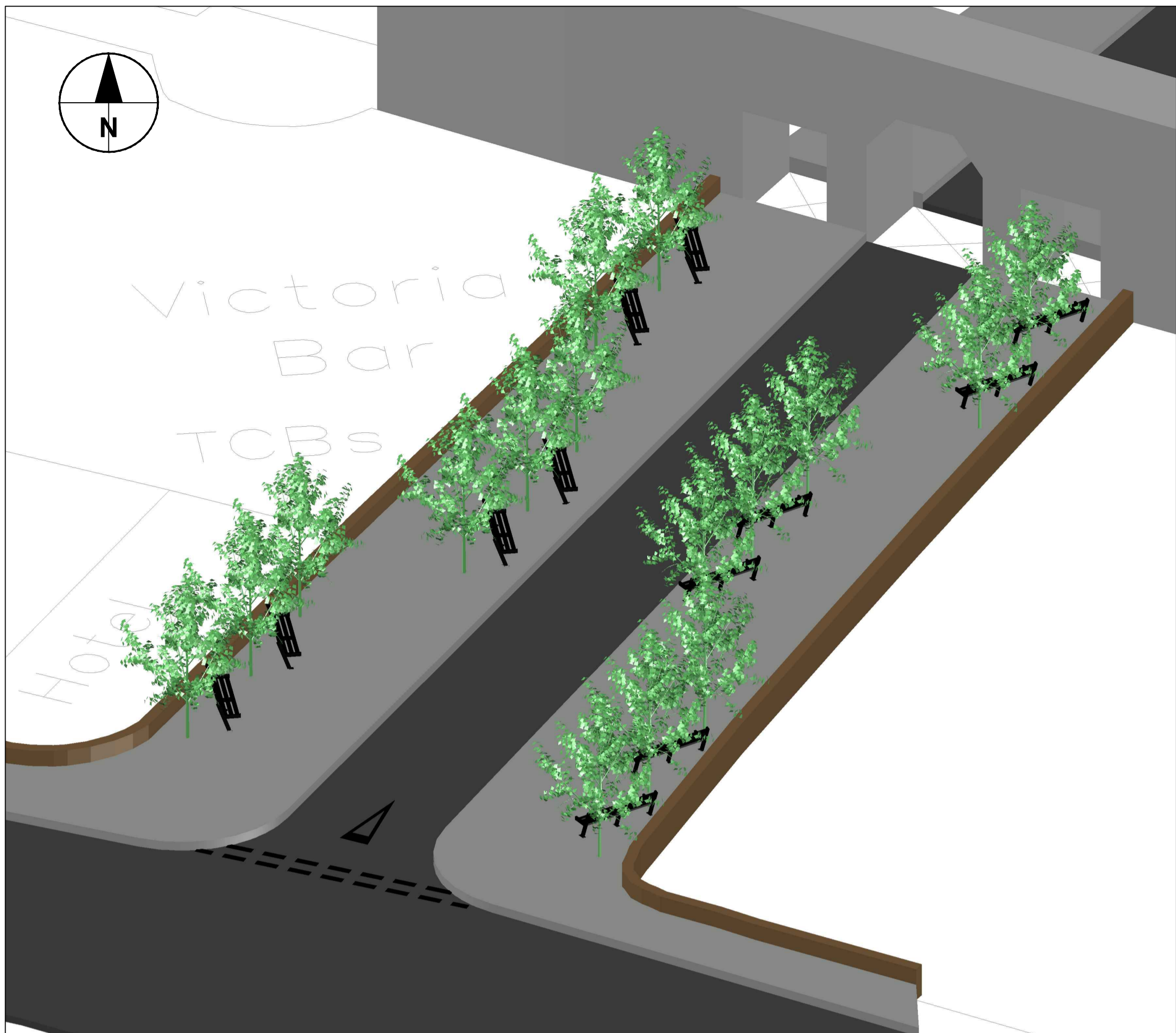

Last saved by: GIBBSO(2019-08-07) Last Plotted: 2019-08-07
 Filename: Z:\UK\UKYRK1\UOBS\IPR-295617_CYC_DESIGN_SUPPORT\1000_CAD_GIS\910_CAD\03_VIC BAR\INITIAL DESIGN\EXIT ALL 3D.DWG